

THIS DRAWING IS UNPUBLISHED. RELEASED FOR PUBLICATION 20
 © COPYRIGHT 20 BY - ALL RIGHTS RESERVED.

| REVISIONS | | | | | |
|-----------|-----|---|-----------|-----|------|
| P | LTR | DESCRIPTION | DATE | DWN | APVD |
| | C4 | NOTES CORRECTED AND PART STATUS UPDATED | 06APR2018 | RK | PS |
| | | | | | |
| | | | | | |

- NOTES:
- MATERIALS AND FINISH
 HOUSING: PA 6-6, UL 94-V0, COLOR: GREEN.
 CLAMP: BRASS, NICKEL PLATED.
 CONTACT SPRING : PHOSPHOR BRONZE, FINISH: SEE TABLE.
 CLAMPING SCREW: M3, BRASS, NICKEL PLATED.
 - MECHANICAL
 MAX. INSERTION FORCE PER POLE : 3.0 N
 MIN. WITHDRAWAL FORCE PER POLE : 1.5 N
 WIRE STRIPPING LENGTH : 6.0-7.5 mm
 RECOMMENDED TIGHTENING TORQUE FOR SCREW : 0.5 Nm.
 - ELECTRICAL
 WIRE RANGE : 12-30 AWG
 MAX. VOLTAGE : 300 V
 MAX CURRENT : 15 A
 CONTACT RESISTANCE : <15 m Ohm
 INSULATION RESISTANCE : >1000 M Ohm (500V DC)
 - INK MARKING: WHITE COLOR.
- $\triangle 5$ TOLERANCE NOT CUMULATIVE.

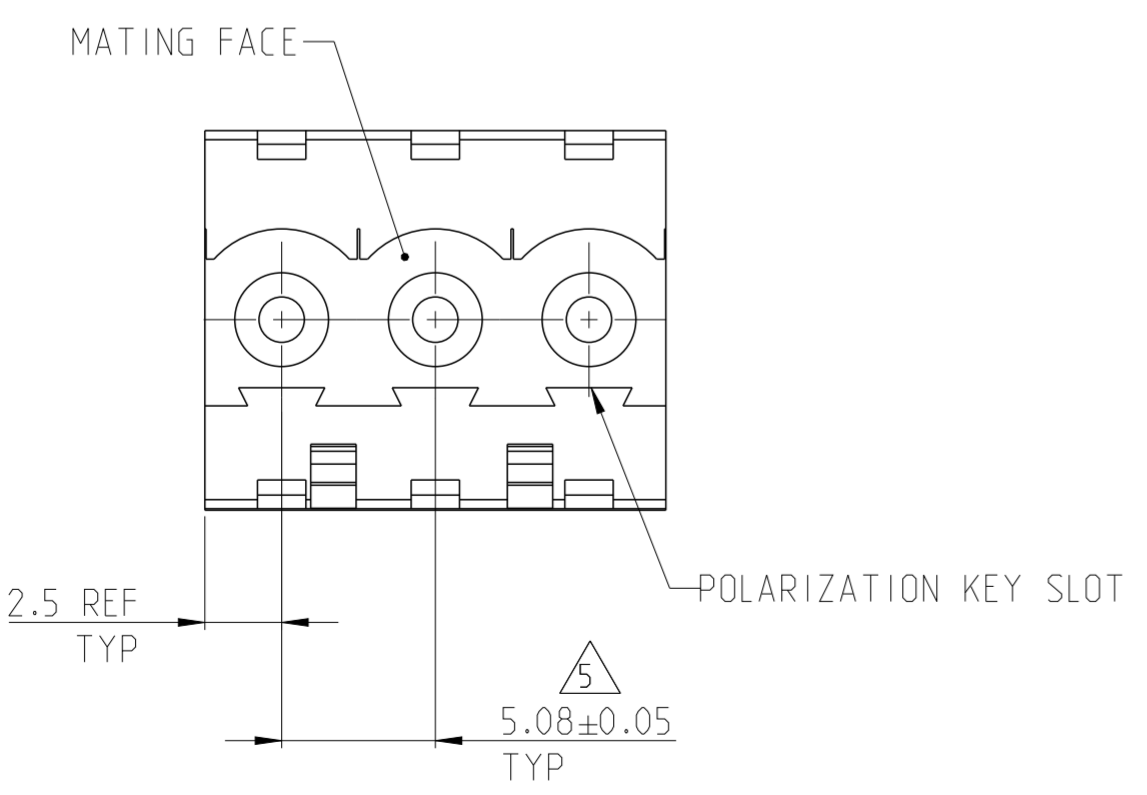
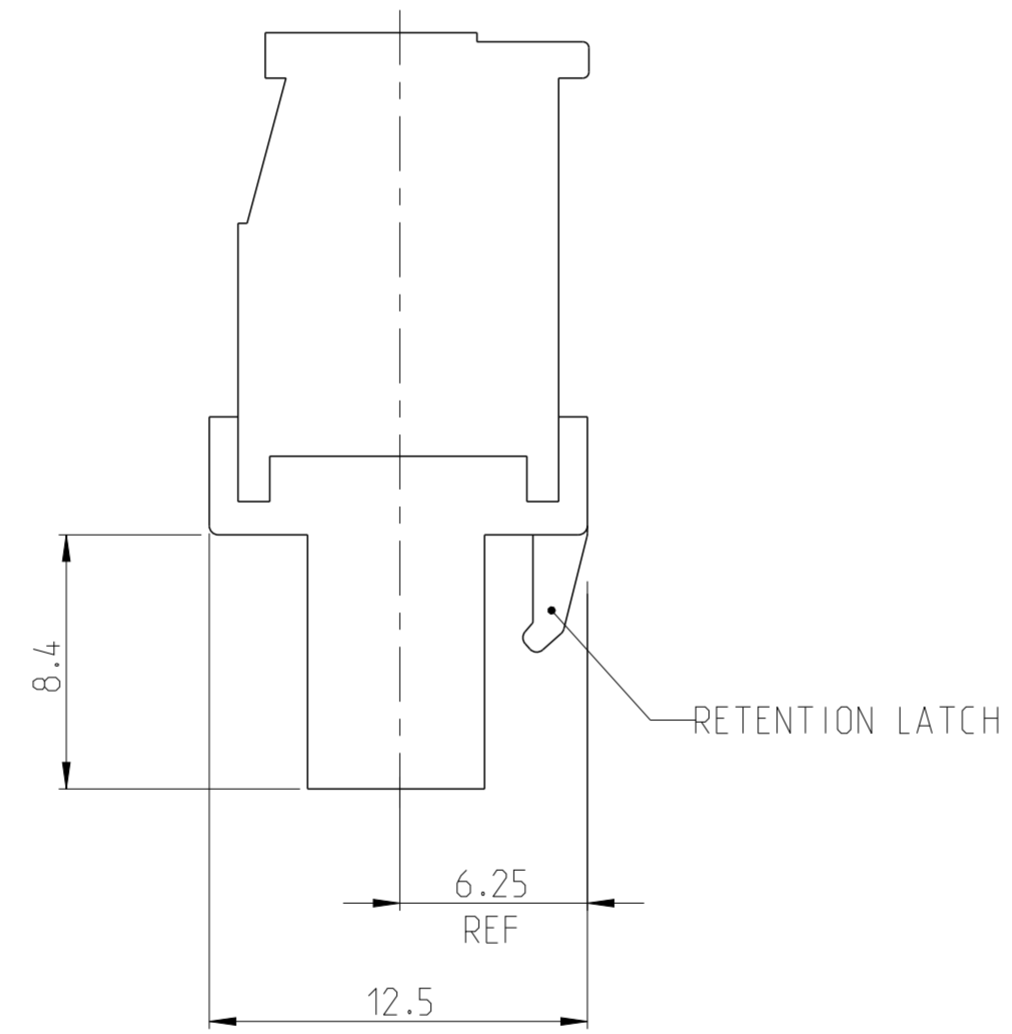
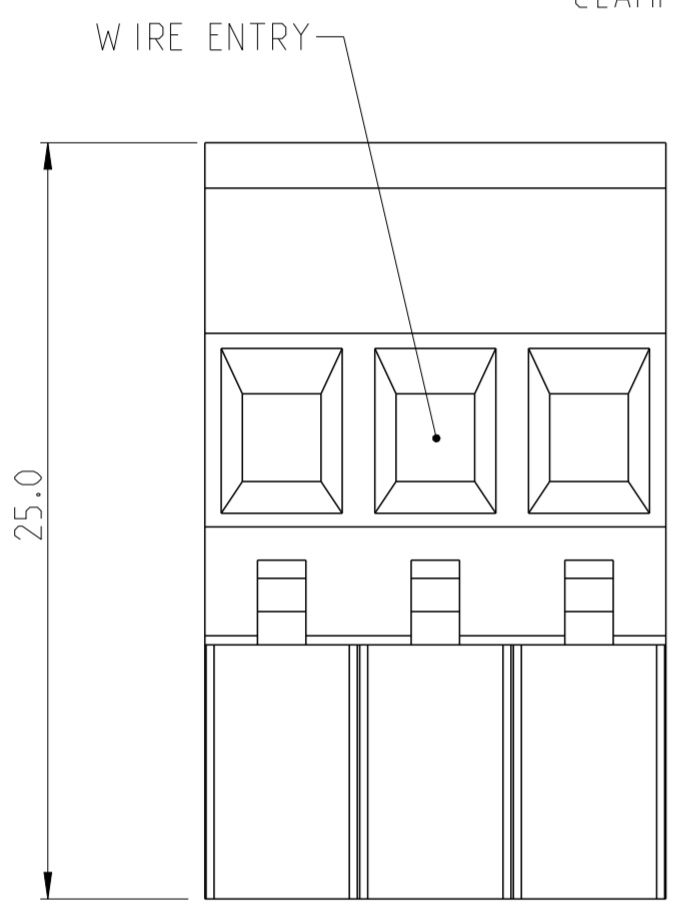
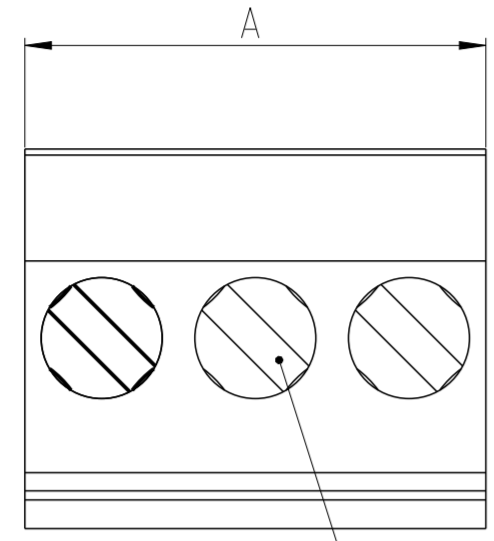

| REV | DESCRIPTION | CONTACT FINISH | MARKING | NO OF POSN | PART NUMBER |
|-------------|----------------|----------------|------------|-------------|-------------|
| PRELIMINARY | SEE DETAIL Z | TIN | 20.32 | 4 | 5-1546105-4 |
| OBSOLETE | SEE DETAIL X | TIN | 60.96 | 12 | 6-1546105-0 |
| OBSOLETE | - | .762 μm GOLD | 50.80 | 10 | 5-1546105-9 |
| OBSOLETE | - | .762 μm GOLD | 40.64 | 8 | 5-1546105-8 |
| OBSOLETE | - | .762 μm GOLD | 35.56 | 7 | 5-1546105-7 |
| OBSOLETE | SEE DETAIL W | TIN | 60.96 | 12 | 5-1546105-6 |
| OBSOLETE | SEE DETAIL V | TIN | 76.20 | 15 | 5-1546105-5 |
| OBSOLETE | SEE DETAIL U | TIN | 45.72 | 9 | 4-1546105-9 |
| OBSOLETE | SEE DETAIL T | TIN | 40.64 | 8 | 4-1546105-8 |
| OBSOLETE | SEE DETAIL S | TIN | 30.48 | 6 | 4-1546105-6 |
| OBSOLETE | SEE DETAIL R | TIN | 20.32 | 4 | 4-1546105-4 |
| OBSOLETE | SEE DETAIL P | TIN | 50.80 | 10 | 4-1546105-0 |
| OBSOLETE | SEE DETAIL N | TIN | 30.48 | 6 | 3-1546105-6 |
| OBSOLETE | SEE DETAIL M | TIN | 25.40 | 5 | 3-1546105-5 |
| OBSOLETE | SEE DETAIL L | TIN | 20.32 | 4 | 3-1546105-4 |
| OBSOLETE | SEE DETAIL K | TIN | 66.04 | 13 | 3-1546105-3 |
| OBSOLETE | SEE DETAIL J | TIN | 50.80 | 10 | 3-1546105-0 |
| - | - | TIN | 127.00 | 25 | 2-1546105-5 |
| - | - | TIN | 121.92 | 24 | 2-1546105-4 |
| - | - | TIN | 116.84 | 23 | 2-1546105-3 |
| - | - | TIN | 111.76 | 22 | 2-1546105-2 |
| - | - | TIN | 106.68 | 21 | 2-1546105-1 |
| - | - | TIN | 101.60 | 20 | 2-1546105-0 |
| - | - | TIN | 96.52 | 19 | 1-1546105-9 |
| - | - | TIN | 91.44 | 18 | 1-1546105-8 |
| - | - | TIN | 86.36 | 17 | 1-1546105-7 |
| - | - | TIN | 81.28 | 16 | 1-1546105-6 |
| - | - | TIN | 76.20 | 15 | 1-1546105-5 |
| - | - | TIN | 71.12 | 14 | 1-1546105-4 |
| - | - | TIN | 66.04 | 13 | 1-1546105-3 |
| - | - | TIN | 60.96 | 12 | 1-1546105-2 |
| - | - | TIN | 55.88 | 11 | 1-1546105-1 |
| - | - | TIN | 50.80 | 10 | 1-1546105-0 |
| - | - | TIN | 45.72 | 9 | 1546105-9 |
| - | - | TIN | 40.64 | 8 | 1546105-8 |
| - | - | TIN | 35.56 | 7 | 1546105-7 |
| - | - | TIN | 30.48 | 6 | 1546105-6 |
| - | - | TIN | 25.40 | 5 | 1546105-5 |
| - | - | TIN | 20.32 | 4 | 1546105-4 |
| - | - | TIN | 15.24 | 3 | 1546105-3 |
| - | - | TIN | 10.16 | 2 | 1546105-2 |
| MARKING | CONTACT FINISH | A | NO OF POSN | PART NUMBER | |

THIS DRAWING IS A CONTROLLED DOCUMENT. DWN S.WELDON 03SEP2002
 CHK C.RICHARD 03SEP2002
 APVD C.RICHARD 03SEP2002

STE TE Connectivity

NAME: TERMINAL BLOCK VERTICAL PLUG
 STACKING LEFT HAND
 5.08mm PITCH

SIZE: A2 CAGE CODE: 00779 DRAWING NO: 1546105 RESTRICTED TO: C4

MATERIAL: SEE NOTES TOLERANCES UNLESS OTHERWISE SPECIFIED: SEE NOTES

0 PLC ±
 1 PLC ±0.3
 2 PLC ±0.25
 3 PLC ±
 4 PLC ±
 ANGLES ±2°
 FINISH

CUSTOMER DRAWING SCALE: 4:1 SHEET: 1 OF 2 REV: C4

THIS DRAWING IS UNPUBLISHED. RELEASED FOR PUBLICATION 20
 © COPYRIGHT 20 BY - ALL RIGHTS RESERVED.

| REVISIONS | | | | | |
|-----------|-----|-------------|------|-----|------|
| P | LTR | DESCRIPTION | DATE | DWN | APVD |
| - | - | SEE SHEET 1 | - | - | - |
| | | | | | |
| | | | | | |

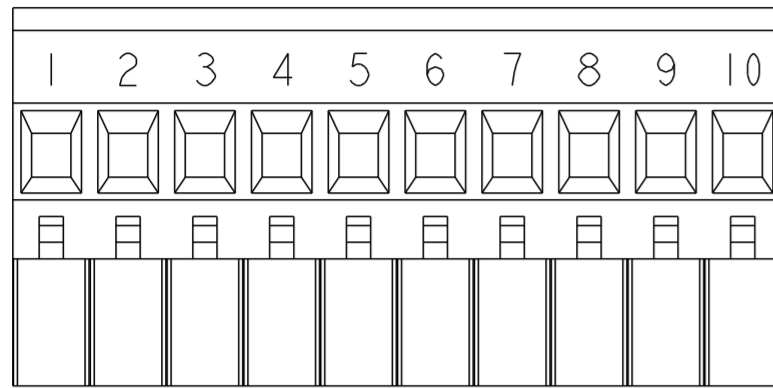

DETAIL J
SCALE 2:1

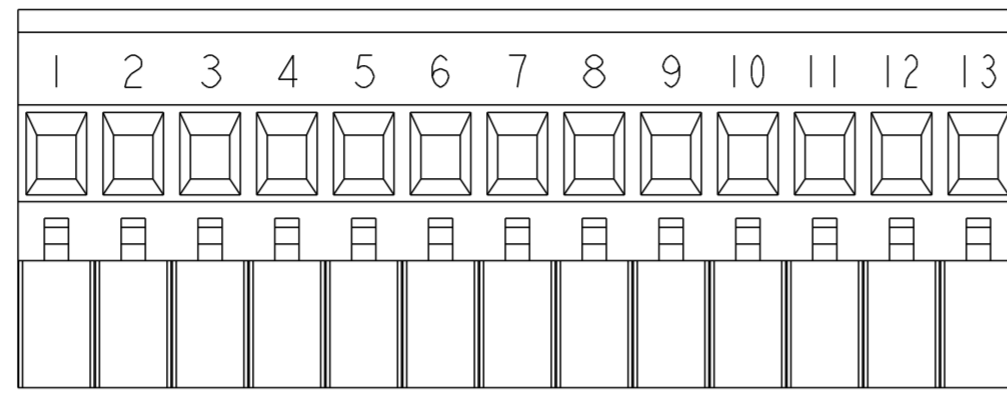

DETAIL K
SCALE 2:1

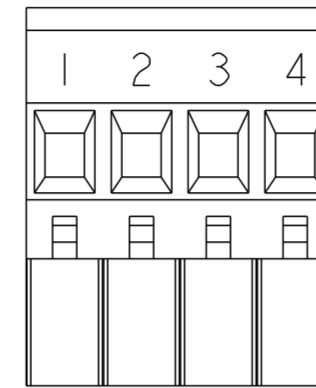

DETAIL L
SCALE 2:1

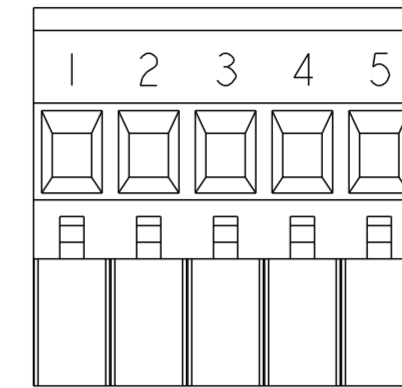

DETAIL M
SCALE 2:1

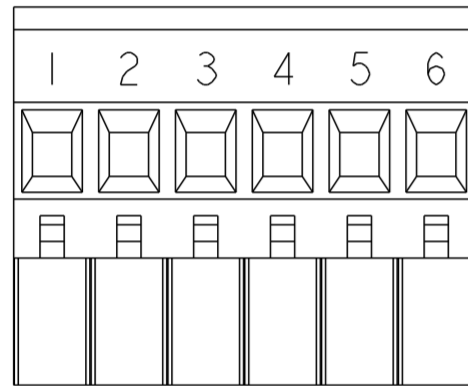

DETAIL N
SCALE 2:1

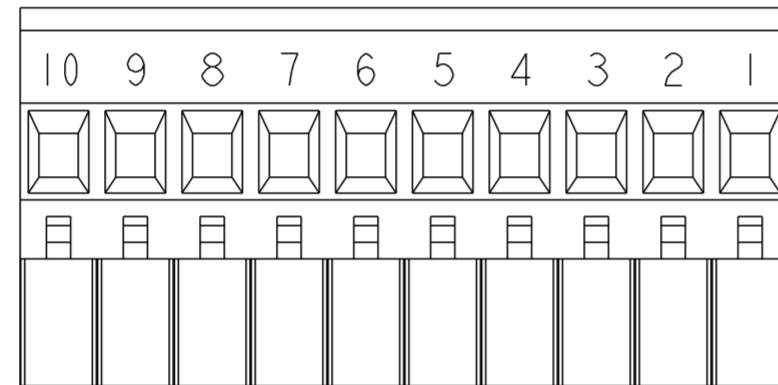

DETAIL P
SCALE 2:1

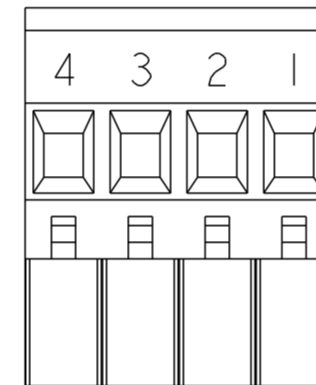

DETAIL R
SCALE 2:1

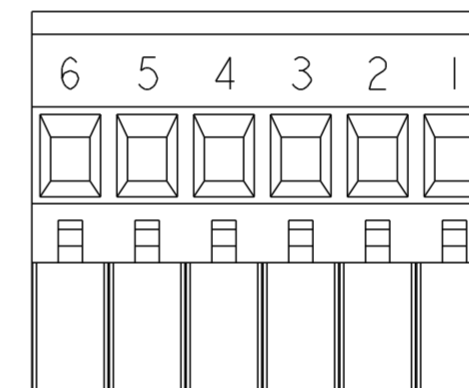

DETAIL S
SCALE 2:1

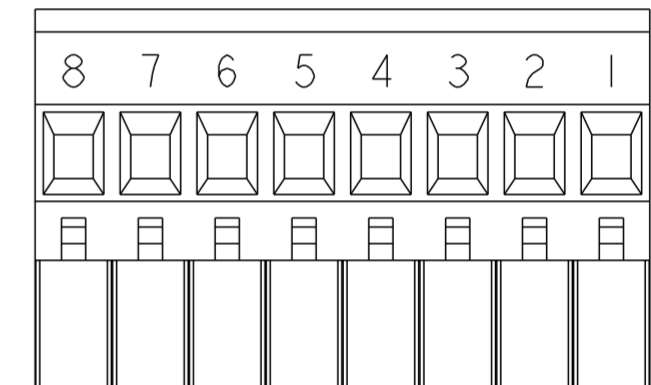

DETAIL T
SCALE 2:1

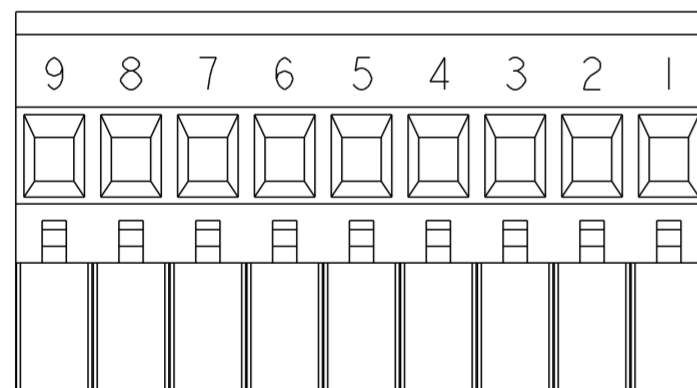

DETAIL U
SCALE 2:1

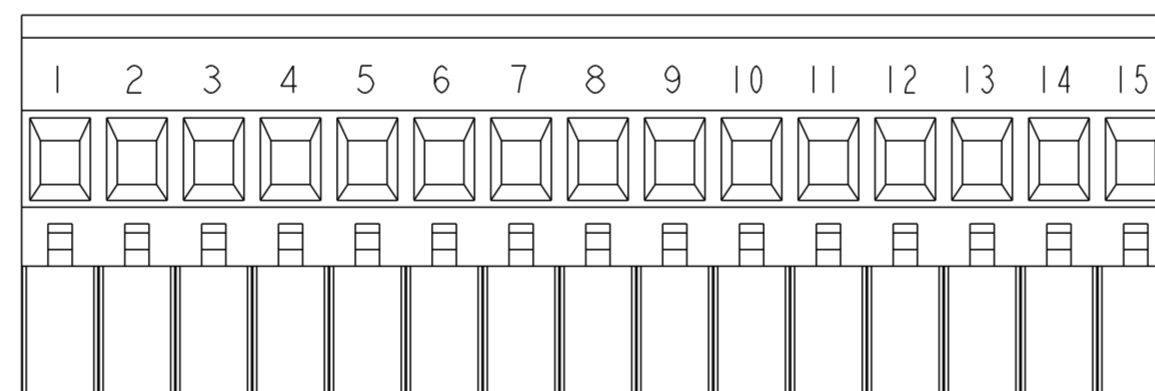

DETAIL V
SCALE 2:1

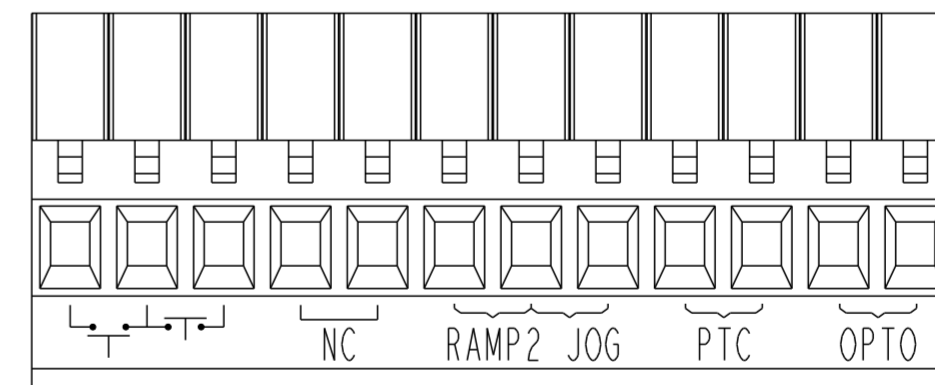

DETAIL W
SCALE 2:1

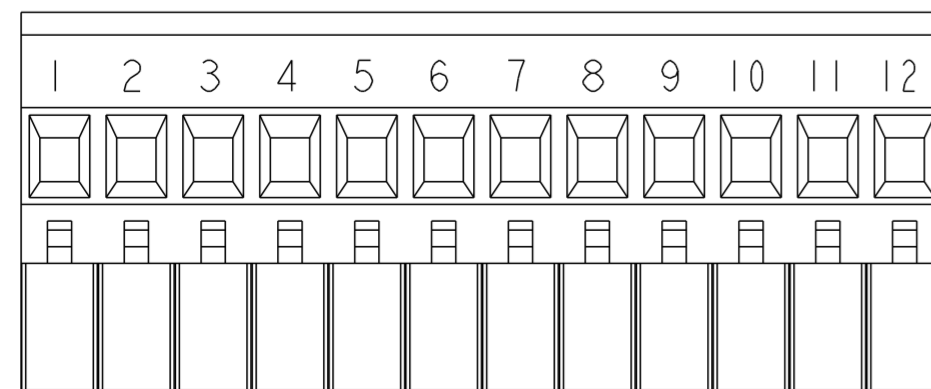

DETAIL X
SCALE 2:1

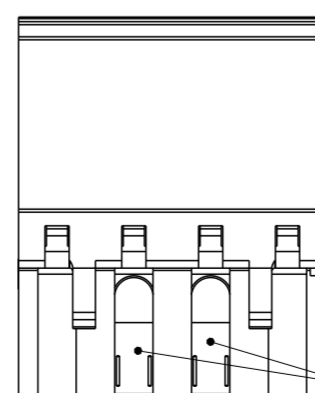

DETAIL Z
SCALE 2:1

CODING KEYS

| | | | |
|--|--|------------------------------|--|
| THIS DRAWING IS A CONTROLLED DOCUMENT. | | DWN S. WELDON 03SEP2002 | TE Connectivity |
| DIMENSIONS: mm | | CHK C. RICHARD 03SEP2002 | |
| TOLERANCES UNLESS OTHERWISE SPECIFIED: 0 PLC ± 1 PLC ±0.3 2 PLC ±0.25 3 PLC ± 4 PLC ± ANGLES ±2° FINISH | | APVD C. RICHARD 03SEP2002 | NAME TERMINAL BLOCK VERTICAL PLUG STACKING LEFT HAND 5.08mm PITCH |
| MATERIAL SEE NOTES | | PRODUCT SPEC - | SIZE A2 |
| | | APPLICATION SPEC - | CAGE CODE 00779 |
| | | WEIGHT - | DRAWING NO 1546105 |
| | | CUSTOMER DRAWING | RESTRICTED TO |
| | | SCALE 3:1 | SHEET 2 OF 2 |
| | | | REV C 4 |