

Touch Panel Accessories

Stylus PRELIMINARY INFORMATION

The Fujitsu-approved Stylus is offered as a convenience to customers for qualifying testing, and for those customers who do not wish to independently source them. Offered in 2 sizes to meet varying end-user requirements.

- N010-0557-T002: Small Polyacetyl Stylus with spring-loaded R0.8mm tip**
 Pen color: black
 Pen end color: white
 Tip hardness: 60°

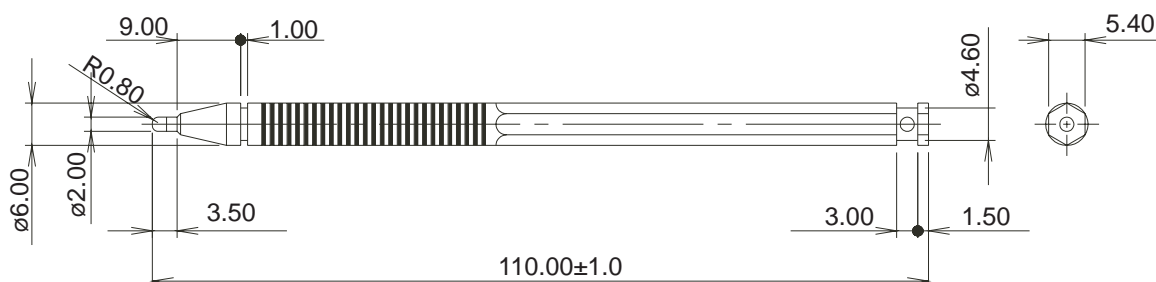

Note: The dimensional tolerance is $\pm 0.5\text{mm}$ unless otherwise specified. Not to scale.

- N010-0557-T011: Large Polyacetyl Stylus with spring-loaded R0.8mm tip**
 Pen color: light gray
 Pen end color: white
 Tip hardness: 60°

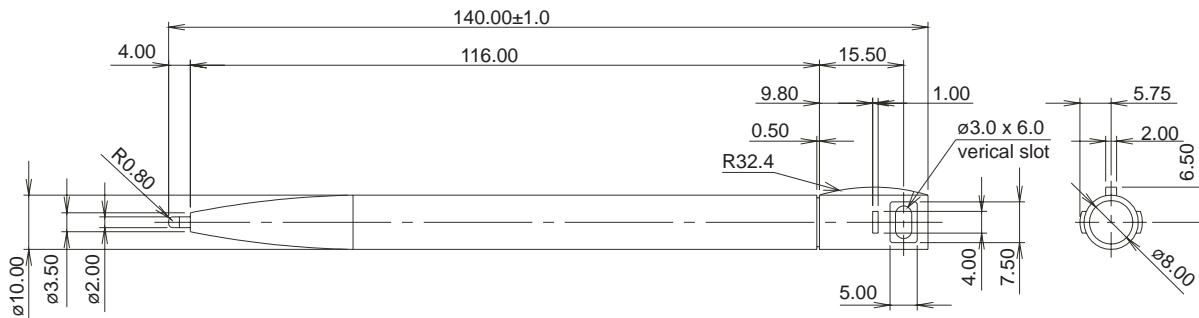

Note: The dimensional tolerance is $\pm 0.5\text{mm}$ unless otherwise specified. Not to scale.

Fujitsu Components International Headquarter Offices

Japan
 Fujitsu Components Limited
 Gotanda-Chuo Building
 3-5, Higashigotanda 2-chome, Shinagawa-ku
 Tokyo 141, Japan
 Tel: (81-3) 5449-7010
 Fax: (81-3) 5449-2626
 Email: promothq@ft.ed.fujitsu.com
 Web: www.fcl.fujitsu.com

North and South America
 Fujitsu Components America, Inc.
 250 E. Caribbean Drive
 Sunnyvale, CA 94089 U.S.A.
 Tel: (1-408) 745-4900
 Fax: (1-408) 745-4970
 Email: marcom@fcai.fujitsu.com
 Web: www.fcai.fujitsu.com

Europe
 Fujitsu Components Europe B.V.
 Diamantlaan 25
 2132 WV Hoofddorp
 Netherlands
 Tel: (31-23) 5560910
 Fax: (31-23) 5560950
 Email: info@fceu.fujitsu.com
 Web: www.fceu.fujitsu.com

Asia Pacific
 Fujitsu Components Asia Ltd.
 102E Pasir Panjang Road
 #04-01 Citilink Warehouse Complex
 Singapore 118529
 Tel: (65) 6375-8560
 Fax: (65) 6273-3021
 Email: fcal@fcal.fujitsu.com
www.fcal.fujitsu.com