

LOC	DIST	REVISIONS					
		P	LTR	DESCRIPTION	DATE	DWN	APVD
GP	00						
			R1	REVISED PER ECO-11-005140	29MAR11	RK	HMR

D

C

B

A

TERMINAL
QUANTITY 50

BLUE COLOR DOT
LOCATED IN CENTER

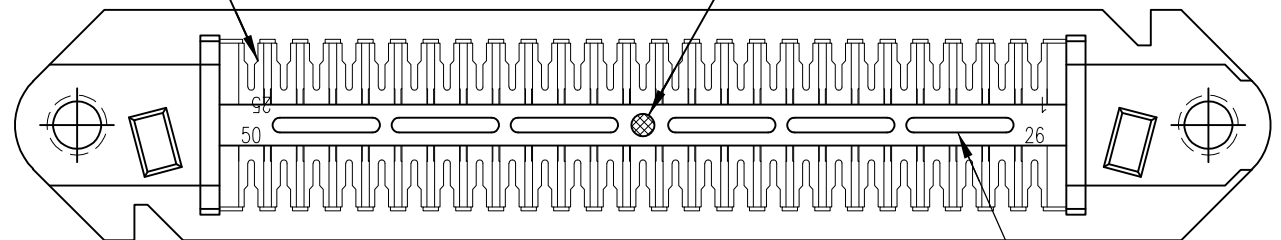

1. THE CONTACT SURFACES OF THE TERMINALS ARE COATED WITH LUBRICANT.
2. ALL DIMENSIONS ARE MAXIMUM UNLESS OTHERWISE SPECIFIED.
3. MATERIAL: HOUSING – THERMOPLASTIC.
TERMINAL – HIGH STRENGTH COPPER ALLOY PLATED WITH 0.76μm [.000030] MIN GOLD OR GOLD FLASH OVER PALLADIUM NICKEL PLATE, 0.76μm [.000030] MIN TOTAL ON MATING SURFACE, OVER 1.27μm [.000050] MIN NICKEL PLATING.
4. WIRE SIZE: 24 & 26 AWG SOLID OR 24 AWG 7 STRANDS OF COPPER CONDUCTORS. MAXIMUM INSULATION DIAMETER OF 1.14[.045] IS ACCEPTABLE FOR MOST APPLICATIONS.
5. CORING MAY OR MAY NOT APPEAR AND IS AT THE DISCRETION OF AMP INCORPORATED.

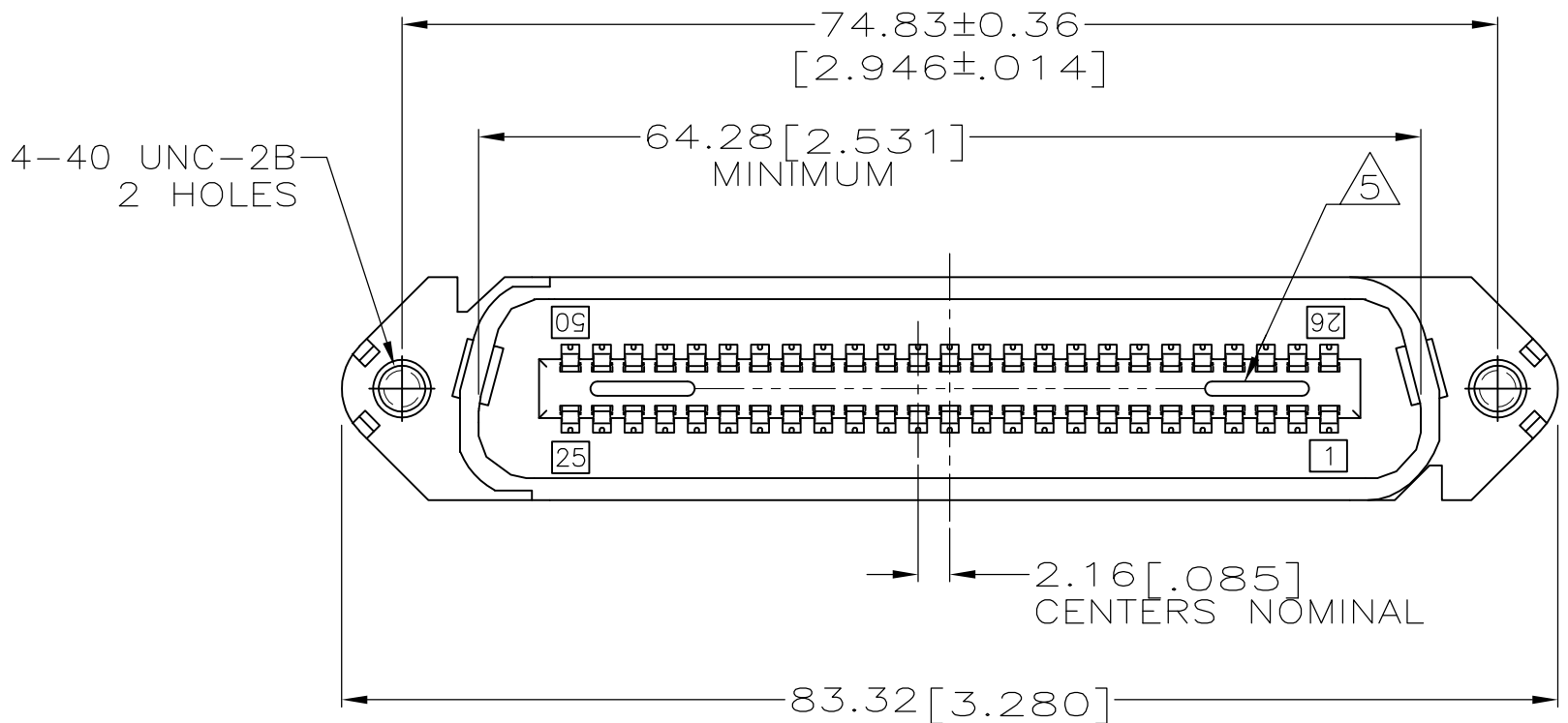
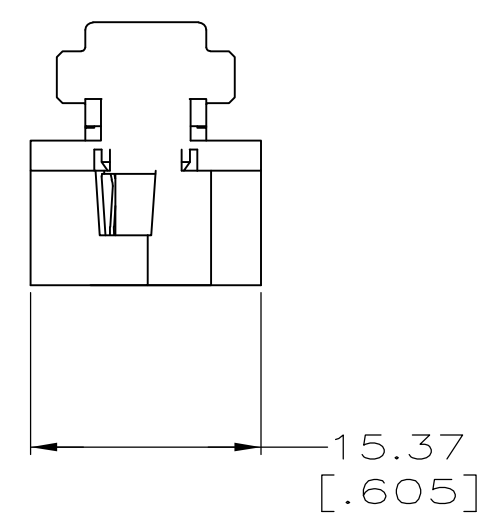
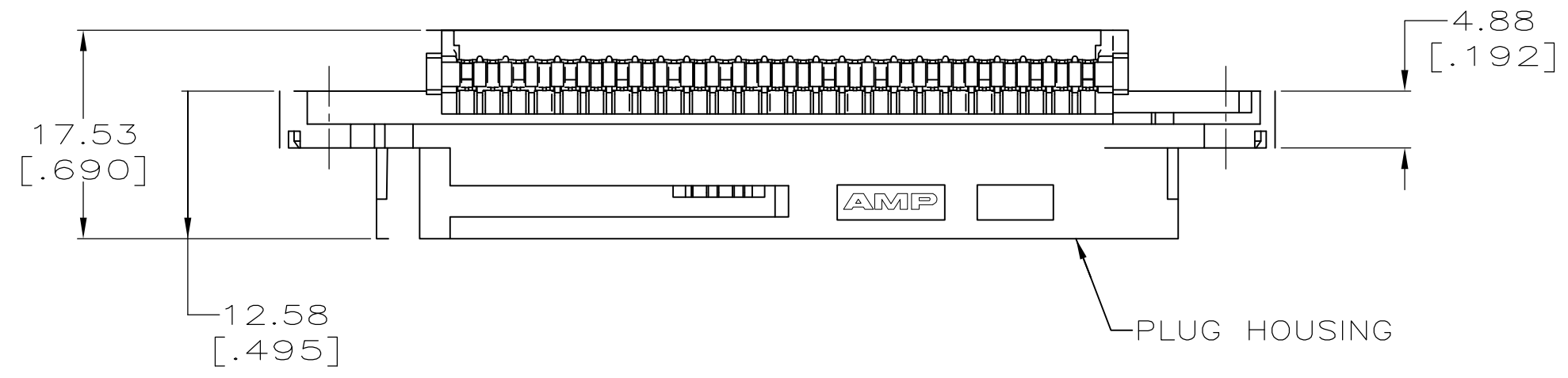

GRAY	229974-4
BLACK	229974-1
COLOR	PART NUMBER

THIS DRAWING IS A CONTROLLED DOCUMENT.		DWN R. HUSSEY 10 JAN 80	TE Connectivity			
		CHK V.E. SLACK 11 JAN 80				
DIMENSIONS: mm [INCHES]		APVD B. WARD 11 JAN 80	NAME PLUG ASSEMBLY, 50 POSITION, B-SLOT, WITH 4-40 HOLES, CHAMP-LOK®			
		PRODUCT SPEC —				
TOLERANCES UNLESS OTHERWISE SPECIFIED:		APPLICATION SPEC —	SIZE A2		CAGE CODE 00779	DRAWING NO C-229974
MATERIAL 3		FINISH 3	WEIGHT —	RESTRICTED TO —		SCALE 2:1
CUSTOMER DRAWING				SHEET 1 OF 1	REV R1	