

0.00"  
0.25"  
0.50"  
0.75"  
1.00"  
1.25"  
1.50"  
1.75"  
2.00"

PROPRIETARY STATEMENT: ULTRAVOLT INC.  
CONFIDENTIAL DRAWING

2

B

PART NUMBER:

BR-006

REV D

SH 1

REVISIONS

LTR	DESCRIPTION	BY	DATE	APPD
A	NEW RELEASE	DS	10/21/97	JM
B	REVISED PER ECO # 2476	DS	10/30/01	JM
C	REVISED PER ECO # 3189	SG	5/5/04	SRO
C1	REVISED PER EC-00510-UV	JC	11/15/07	SRO
D	REVISED PER EC-00361-UV	JC	7/15/08	SRO

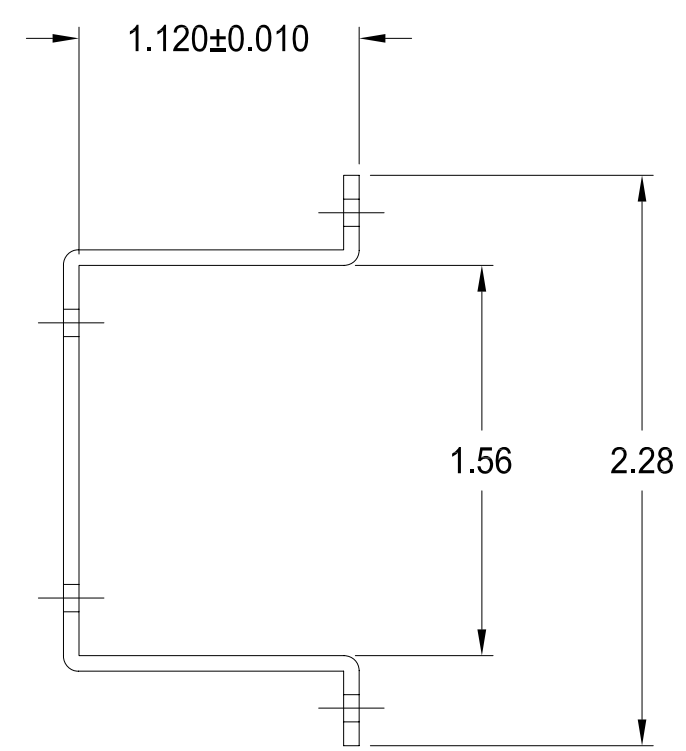
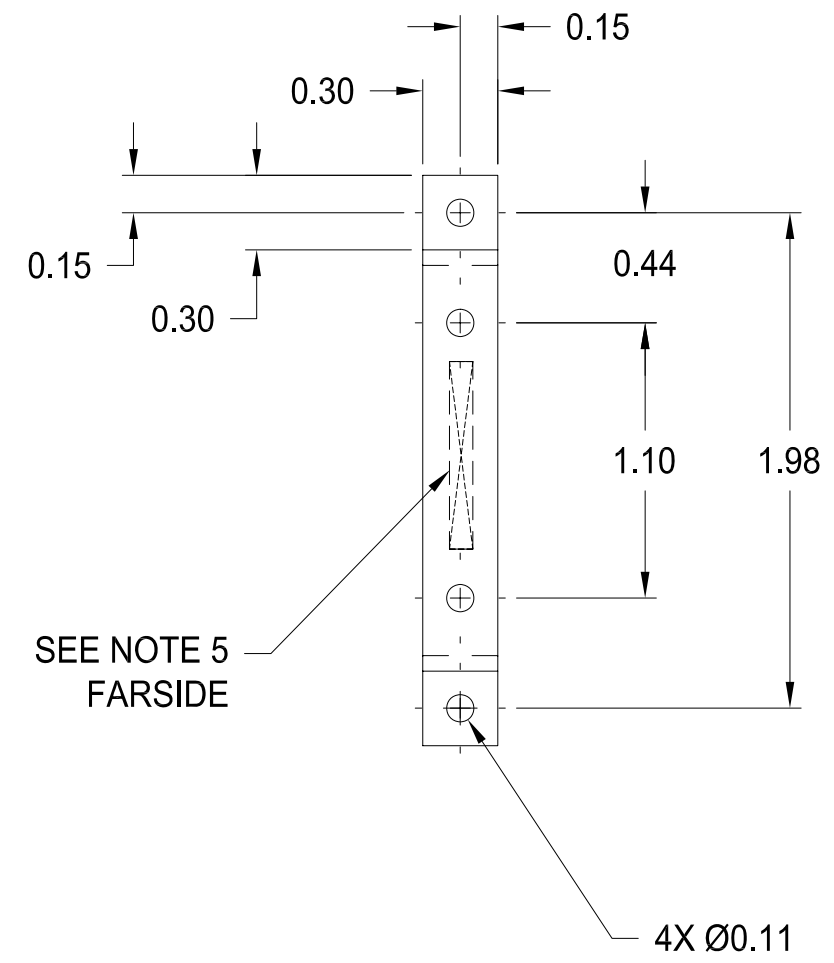

- NOTES:
1. MATERIAL: 0.062 THK. ALUMINUM ALLOY 5052-H32 PER QQ-A-250/8
  2. FINISH: DARK MATTE, BLACK ANODIZED PER MIL-A-8625
  3. ALL BENDS ARE TO BE SHARP.
  4. REMOVE ALL BURRS AND SHARP EDGES.
  5. MARK PART NUMBER AND REVISION. STAMP OR USE A NON-CONDUCTIVE INDELIBLE INK, (FREE OF CARBON) CONTRASTING COLOR, 0.09-0.125 HIGH CHARACTERS LOCATE APPROXIMATELY AS SHOWN. i.e. XX-XXX\_revX.

DASH NUMBER	NEXT ASSY	USED ON
APPLICATION		

UNLESS OTHERWISE SPECIFIED DIMENSION ARE IN INCHES TOLERANCES ARE:		CUSTOMER	
2 PL DEC ± .02	FRACT ± 1/64	DRAWN	DATE
3 PL DEC ± .010	ANGLES ± 2°	CHKD	12/18/97
HOLE DIA	TOLERANCES	MFG	N/A
.0135 THRU .125	+ .004 - .004	MFG ENGR	12/18/97
.126 THRU .250	+ .005 - .005	PROCESS	N/A
.251 THRU .500	+ .006 - .006	QA	N/A
.501 THRU .750	+ .008 - .008	CHIEF ENG	12/18/97
.751 THRU 1.000	+ .010 - .010	CFN: BR-003_revD.dwg	
1.001 THRU 2.000	+ .012 - .012		

**ULTRAVOLT, INC.**  
1800 OCEAN AVE. FRNT, RONKONKOMA, N.Y. 11779  
1-631-471-4444

BRACKET, ("10A" W/AUX, "15FL12" & "20A" W/AUX)  
(BRACKET KIT OPTION ORDER BR-6 KIT)

PART NUMBER: **BR-006** REV **D**

SCALE NONE DO NOT SCALE THIS DRAWING SHEET 1 OF 1

2

1